

FIT EOS SURFACE

INSTALLATION MANUAL



FIT EOS SURFACE - EXTENSION CLIP

Installation Manual

- Step 1** Measure the distance between the power feed and end cap to determine the required strip length.

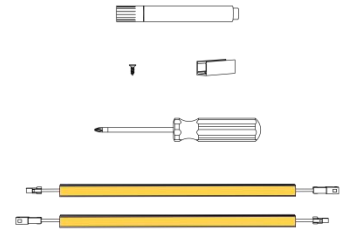

- Step 2** Align the connectors of two LED strips and gently push them together. Ensure correct polarity alignment. Gently pull to confirm secure connection.

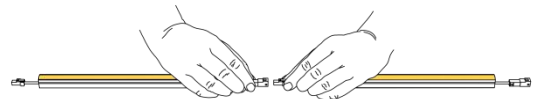

- Step 3** Place each connected LED strip into the mounting clip. Carefully press the LED strips into the clip channels, ensuring they're fully seated with the strip surface flush with the clip edge.



- Step 4** Draw a line on the mounting surface to ensure multiple strips align perfectly. Use an erasable marker and a ruler or level for accuracy.

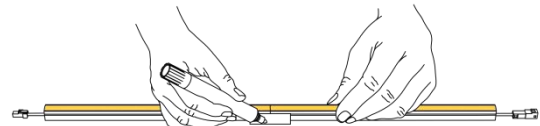

- Step 5** Use the screwdriver and screws to secure clips to the mounting surface.

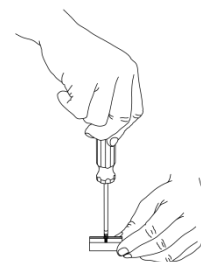

- Step 6** Properly installed FIT EOS SURFACE LED strips should appear neat and aligned, fully seated in clips with no visible gaps at connections.



FIT EOS SURFACE – MAGNETIC CLIP

Installation Manual

Step 1 Before you begin, measure your installation area carefully to plan the required fixture length and the number of magnetic bases needed.

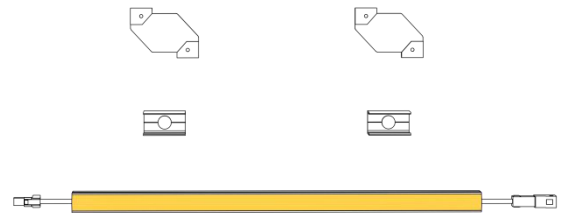

Step 2 Position magnetic mount bases at your installation location. Space them evenly, typically every 20-30 inches. Secure bases using either adhesive backing or screws. Attach magnetic connectors to the back of the LED strip. Position connectors to align with the mounted bases. Ensure connectors are firmly attached to the strip with no movement.

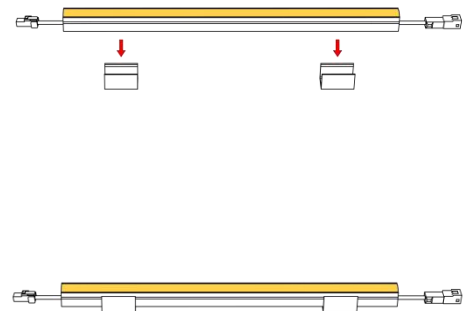

Step 3 Rotate each magnetic clip clockwise until you hear a click, as indicated by the diagram arrows. This locking action secures the clips in place and prevents the fixture from detaching if it is pulled or bumped during use.

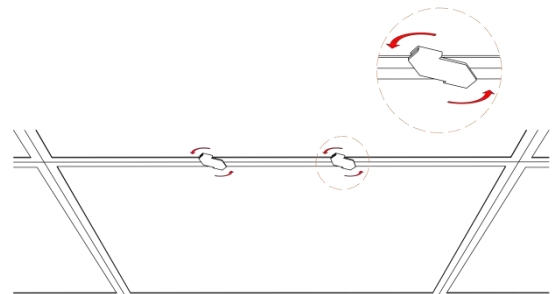

Step 4 Align the LED strip with attached connectors to the magnetic bases on your installation surface. Gently push upward until the magnets connect. The magnetic design allows for easy installation and removal for maintenance.

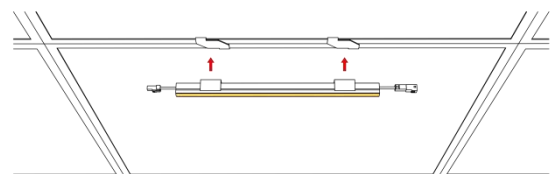

FIT EOS SURFACE – MAGNETIC CLIP

Installation Manual

Step 5 Once the fixture is secured, check the alignment and stability. Connect it to the power supply and test to confirm even illumination along the entire length, with no flickering or loose connections. When installed correctly, the FIT EOS SURFACE will provide a clean, professional appearance.

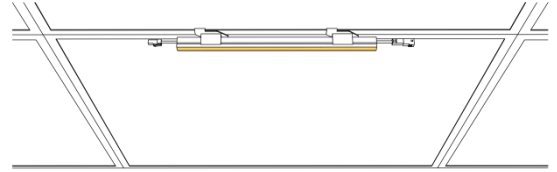

Maintenance Tips:

1. To remove for cleaning, gently pull the strip downward to separate from the magnetic bases.
2. Periodically check magnetic strength to ensure secure attachment.
3. Always disconnect power before cleaning; use a soft cloth and avoid chemical cleaners.
4. Contact customer service if you notice flickering or dark spots.
5. Avoid installation in high-temperature or high-humidity environments.
6. Magnetic mounts work on most flat surfaces; some special materials may require additional securing methods.

Beamever

Designer's Custom Playground

Beamever Inc.
100 N Howard St Ste R.
Spokane, WA, 99201-0508 USA
info@beamever.com
www.beameverusa.com